

G 90 series Consumer

Model:
G 90
G 90 Allergy

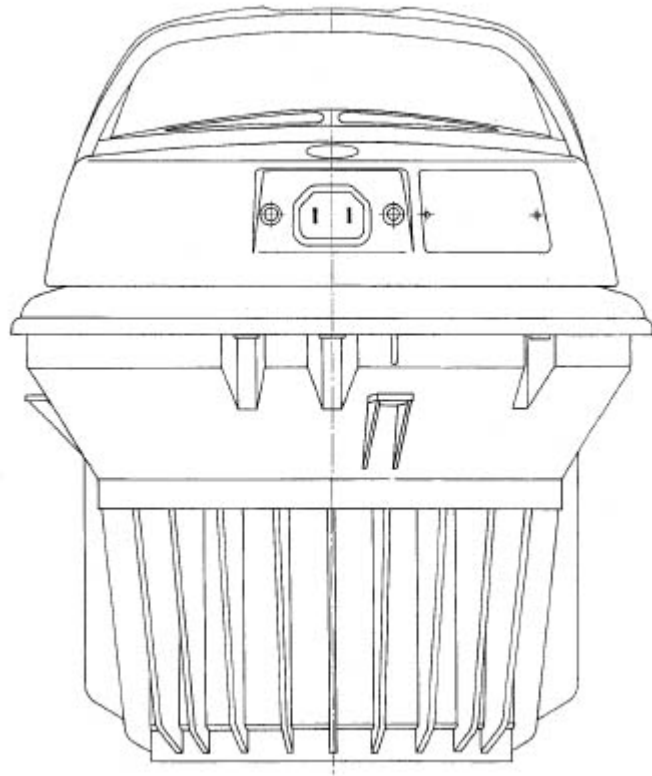

Stückliste Deutsch

08-02-2015

Inhalt

G 90 series Consumer

Motorkopf, alle Modelle	3
Motor and motor wire, all models ALL	5
Cords consumer	7
ABLUFTFILTER UND SCHALLDÄMPFER	9
DIFFUSOR, FILTER GS/GM 81	11
Upper/lower container with accessory consumer	13
EINLASSKUPPLUNG UND SCHLÄUCHE 38-32 MM	15
DÜSEN 32 MM	17

Motorkopf, alle Modelle

G 90 series Consumer

08-02-2015

ET-Liste-Nr.

A0933

3

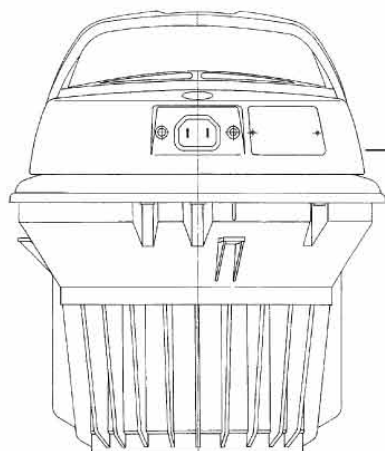

1

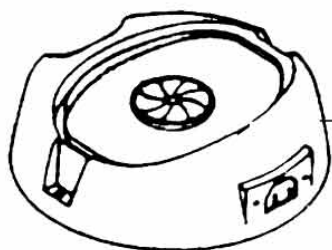

10

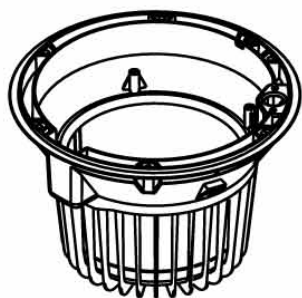

12

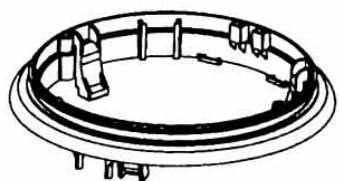

11

20

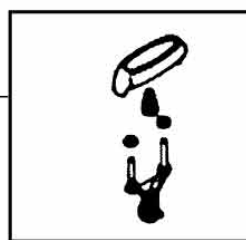

21

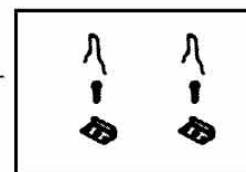

22

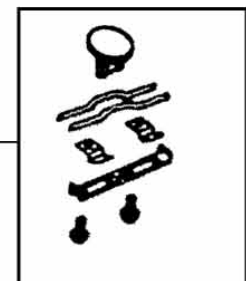

23

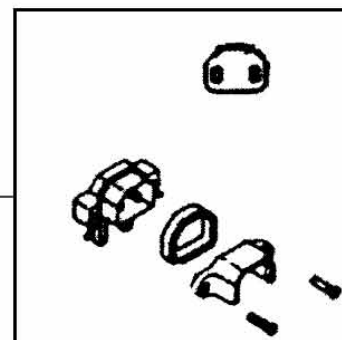

24

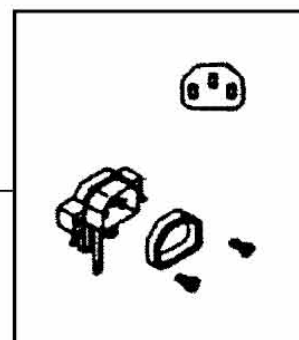

Motorkopf, alle Modelle

G 90 series Consumer

08-02-2015

ET-Liste-Nr.

A0933

4

Pos	Artikelnr.	Me	Beschreibung	
1	12108127	1	MOTOR GSP 100V JAPAN	100V, 700W
1	12108129	1	Motor GSP 110-120V USA	110-120V, 800W
1	12108148	1	MOTOR GSP 200V JAPAN	200V, 700W
1	12108153	1	Motor GSP 220-240V/800W	220-240V, 800W
1	12108253	1	MOTOR GSP M.F.LEDN.EU/AUS	
1	12108329	1	Motor GSPJ, 110-120V.UL	
1	12108348	1	MOTOR GSPJ 200V JAPAN	
1	12108353	1	Motor GSPJ 220-240 V AUS	220-240, 800W
1	12110127	1	MOTOR GMP 100V JAPAN	100V, 850W
1	12110129	1	Motor GMP 110-120V	110-120V, 1100W
1	12110327	1	MOTOR GMPJ 100V JAPAN	100V, 850W
1	12110329	1	Motor GMP J 110-120 V UL	110-120V, 1100W
1	12112153	1	MOTOR GMP 220-240V EU/AU/	220-240V, 1200W
1	12112253	1	Motor GMP, 1200W., 230V.	220-240V, 1200W
1	12112353	1	Motor GMPJ 1200W 3ph 240V	220-240V, 1200W
10	22232300	1	Deckel Motor GSP/GMP/KS	
11	22232500	1	Motorzwischenring f. GS/	
12	22231200	1	Standkorb f. Motor GS/GM	
12	22231201	1	BOTTOM HOUSING WITH WALVE	UL-APPROVED
20	22410500	1	Ein- Aus Schalter GM 80	
21	22410400	1	Handle Kit	
22	20705300	1	Thermovenlilkit f.	
23	20705400	1	Steckbuchsenkit	
24	20705500	1	SOCKET EARTHED W. PARTS	

Motor and motor wire, all models ALL

G 90 series Consumer

08-02-2015

ET-Liste-Nr.

A0935

5

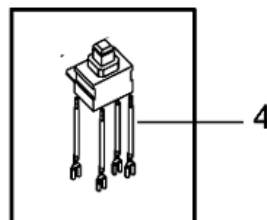
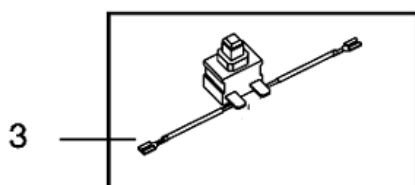
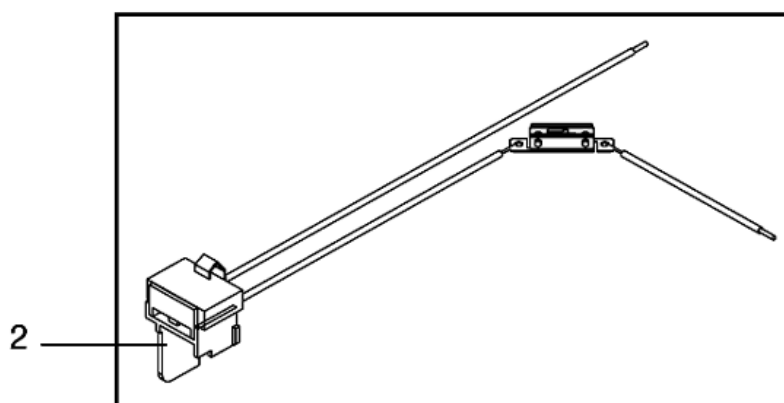
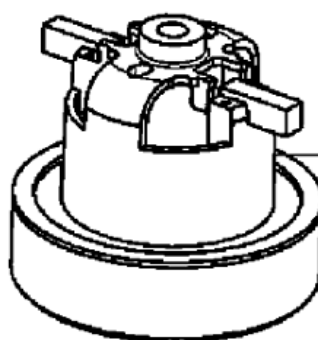
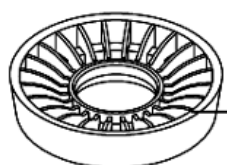
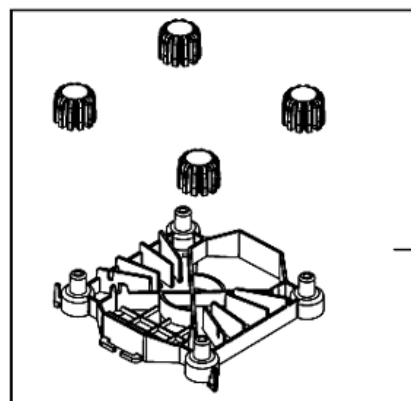
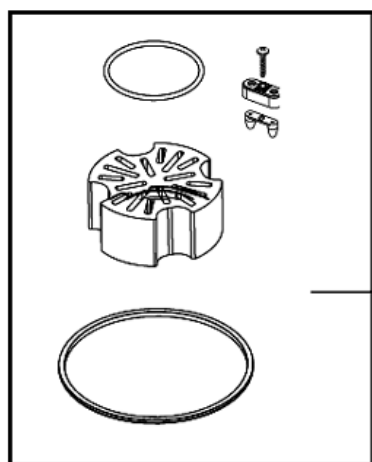

Motor and motor wire, all models ALL

G 90 series Consumer

08-02-2015

ET-Liste-Nr.

A0935

6

Pos	Artikelnr.	Me	Beschreibung
1	12125001	1	Motoreinsatz 800W (GSP/GD
1	12125002	1	Motoreinsatz 220-240V 800W
1	12125003	1	MOTOR 110-120V AMETEK
1	12125005	1	Motoreinsatz GMP 240V/1200 W
2	22130500	1	Kabelkit f.GSP/GMP
2	22130501	1	Kabelkit m.Thermoschalter
3	22131100	1	Schalter Set GS-Motoren2-Polig
4	22131200	1	Schalter Set GM-Motoren4-Polig
10	107401268	1	Motorkit
10	22231100	1	Motorschalldämpfer GD1005
11	22365300	1	Schalldämpfer u. Dichtungzu GS/GM Motor
12	22399800	1	GASKET FOR INLET

Cords consumer

G 90 series Consumer

08-02-2015

ET-Liste-Nr.

A0937

7

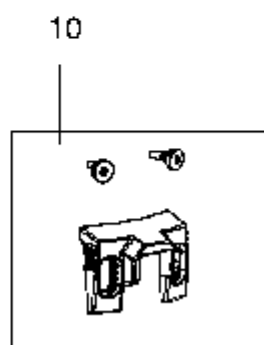
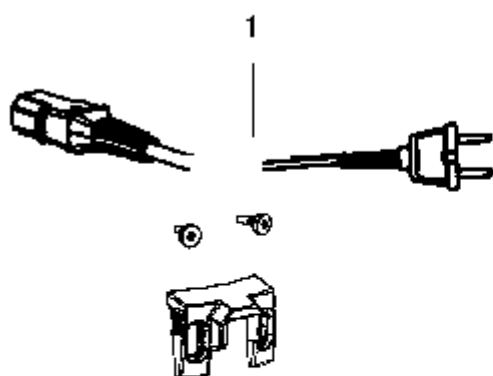

Cords consumer

G 90 series Consumer

08-02-2015

ET-Liste-Nr.

A0937

8

Pos	Artikelnr.	Me	Beschreibung
1	21548000	1	Kabel 7m, EU
1	21746500	1	Kabel 7m 2 x 1,5 / UK
1	21905400	1	7M CORD 2X1.0 CON./AUSANDNZ
1	21907900	1	7M CORD 2X1.0 CON./CH
1	21952200	1	Kabel 9,3m / US
10	22361000	1	Kabelsicherung zuGM-GS Motoren

ABLUFTFILTER UND SCHALLDÄMPFER

G 90 series Consumer

08-02-2015

ET-Liste-Nr.

A0939

9

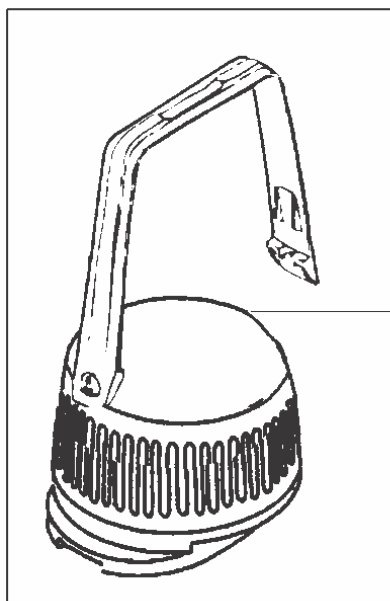

1

4B

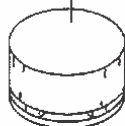

4

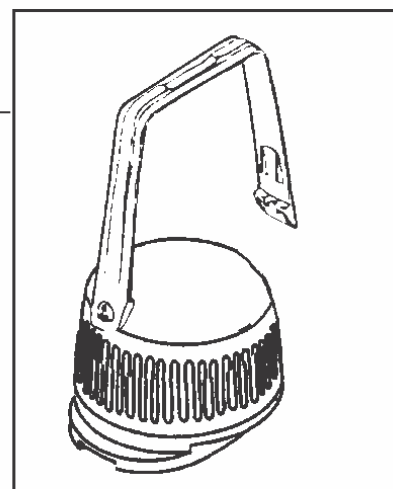

2

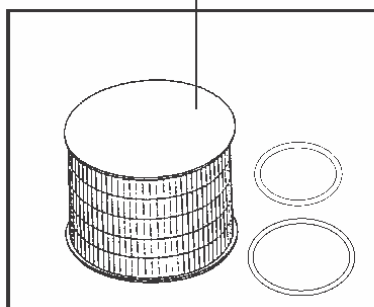

3

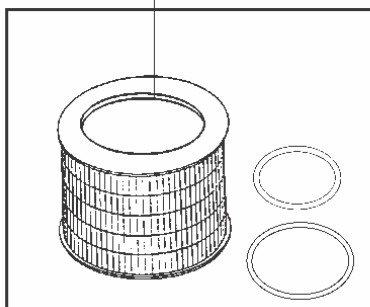

4A

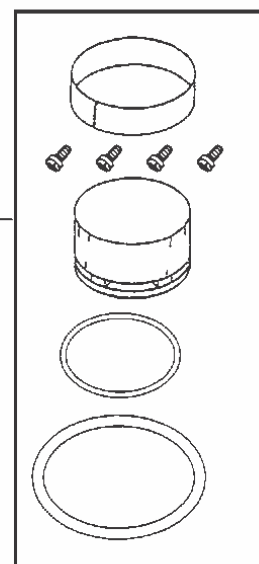

9

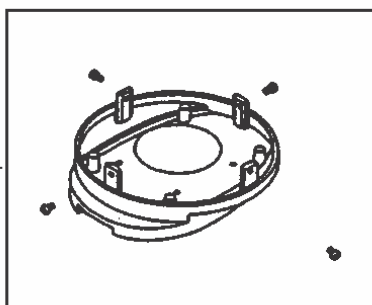

5

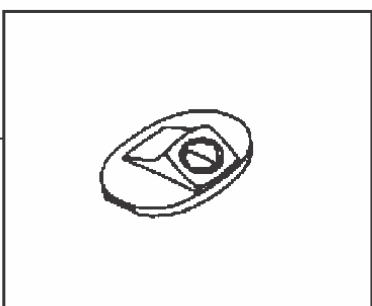

HEPA

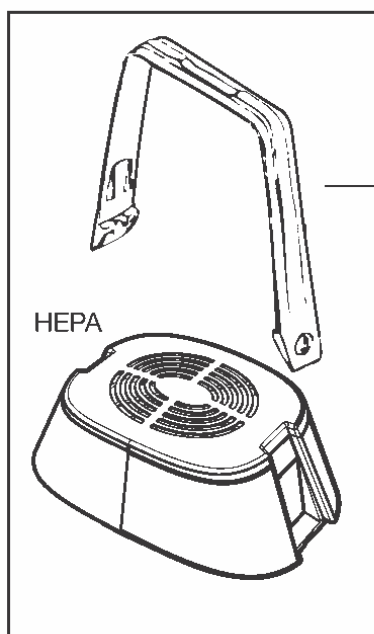

6

7

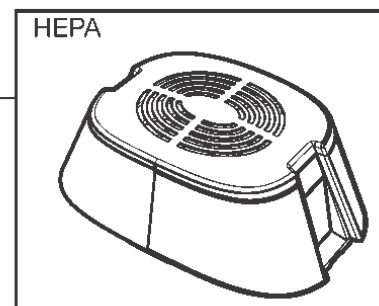

ABLUFTFILTER UND SCHALLDÄMPFER

G 90 series Consumer

08-02-2015

ET-Liste-Nr.

A0939

10

Pos	Artikelnr.	Me	Beschreibung
1	11731003	1	Abluftfiltergehäuse 32 mm zu HEPA/ULPA o.
2	21738000	1	Absolutfilterpatrone GS/GM
4	11750703	1	Schalldämpfer GS/GM
5	11562000	1	Blasaufsatz GS/GM 38 mm
6	82146700	1	HEPA-Filter Starter Kit
7	82147100	1	HEPA-Filterpatrone GS/GM zu 82146700 zu P
9	22383900	1	Basis für Filtergehäuse GM
4A	11750703	1	Schalldämpfer GS/GM
4B	21750900	1	LYDELEMENT KOMPL.

DIFFUSOR, FILTER GS/GM 81

G 90 series Consumer

08-02-2015

ET-Liste-Nr.

A09311

11

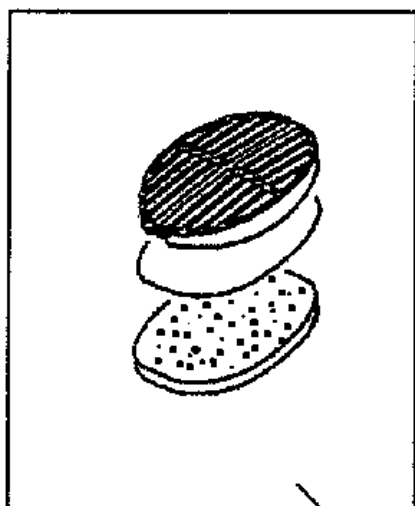

1



2

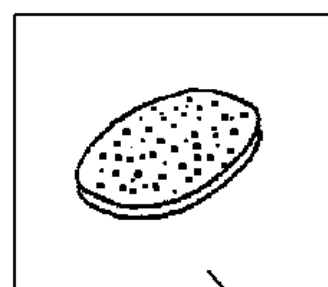

10



4

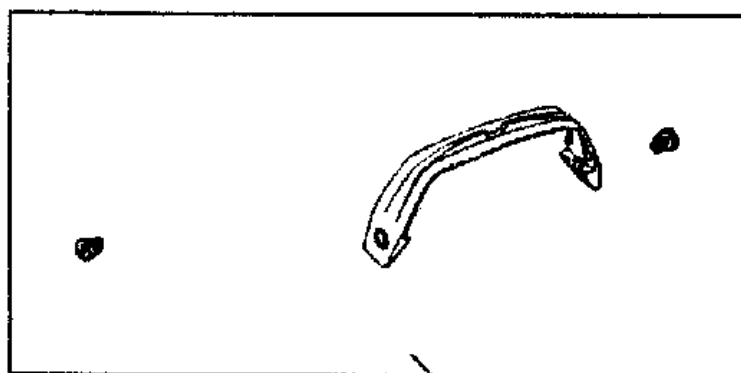

5

DIFFUSOR, FILTER GS/GM 81

G 90 series Consumer

08-02-2015

ET-Liste-Nr. A09311

12

Pos	Artikelnr.	Me	Beschreibung
1	22394900	1	EXHAUST FILTER WITH
2	11641000	1	Micro-Static-Filter(2 Stück) grau * See NOTE
4	11730410	1	Filter-MotorschutzPoly ester
5	22132000	1	Motortraggriff -Kit GS/GM
5	81527801	2	Schlosszapfen GS/GMTraggriff FOR FIXING THE HANDLE

* Note: The filters have a 'black' and a 'white' side to it. The black one should be facing up

Upper/lower container with accessory consum

G 90 series Consumer

08-02-2015

ET-Liste-Nr.

A09313

13

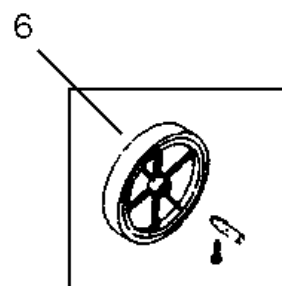
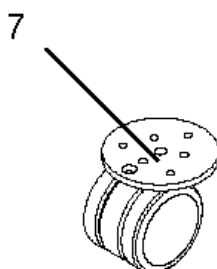
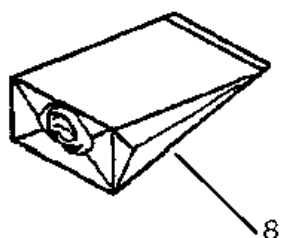
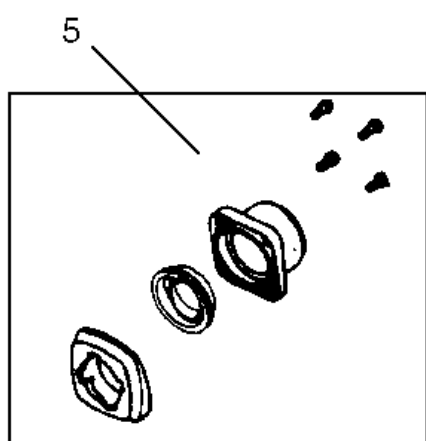
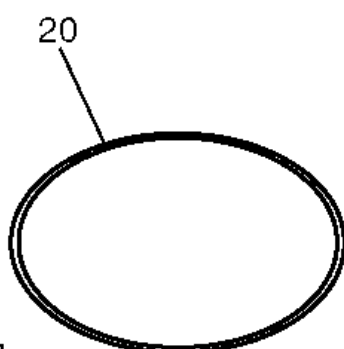
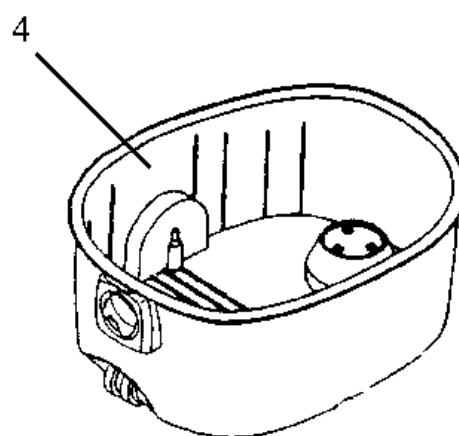
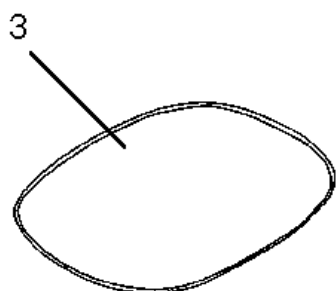
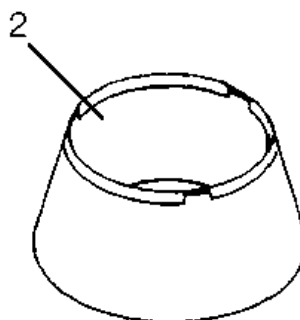

Upper/lower container with accessory consum

G 90 series Consumer

08-02-2015

ET-Liste-Nr.

A09313

14

Pos	Artikelnr.	Me	Beschreibung
1	22142100	1	Kesselklammern GM 90 2Stk
2	61588200	1	Baumwoll-Filter GS/GM 9032mm komplet
3	81991300	1	Filter BW/GS 90C
4	22142200	1	Kessel-Unterteil GS90(Dunkelgrau)
5	22142300	1	Bajonet kompl. zu GM80
6	12009300	1	Rad-Achse GS 90
7	147 1040 500	1	Drehrad kompl. zuExtreme/GM 430
8	82095000	1	PAPIERSÄCKE f. GM 80
20	82190600	1	Motordichtung

EINLASSKUPPLUNG UND SCHLÄUCHE 38-32

G 90 series Consumer

08-02-2015

ET-Liste-Nr.

A09315

15

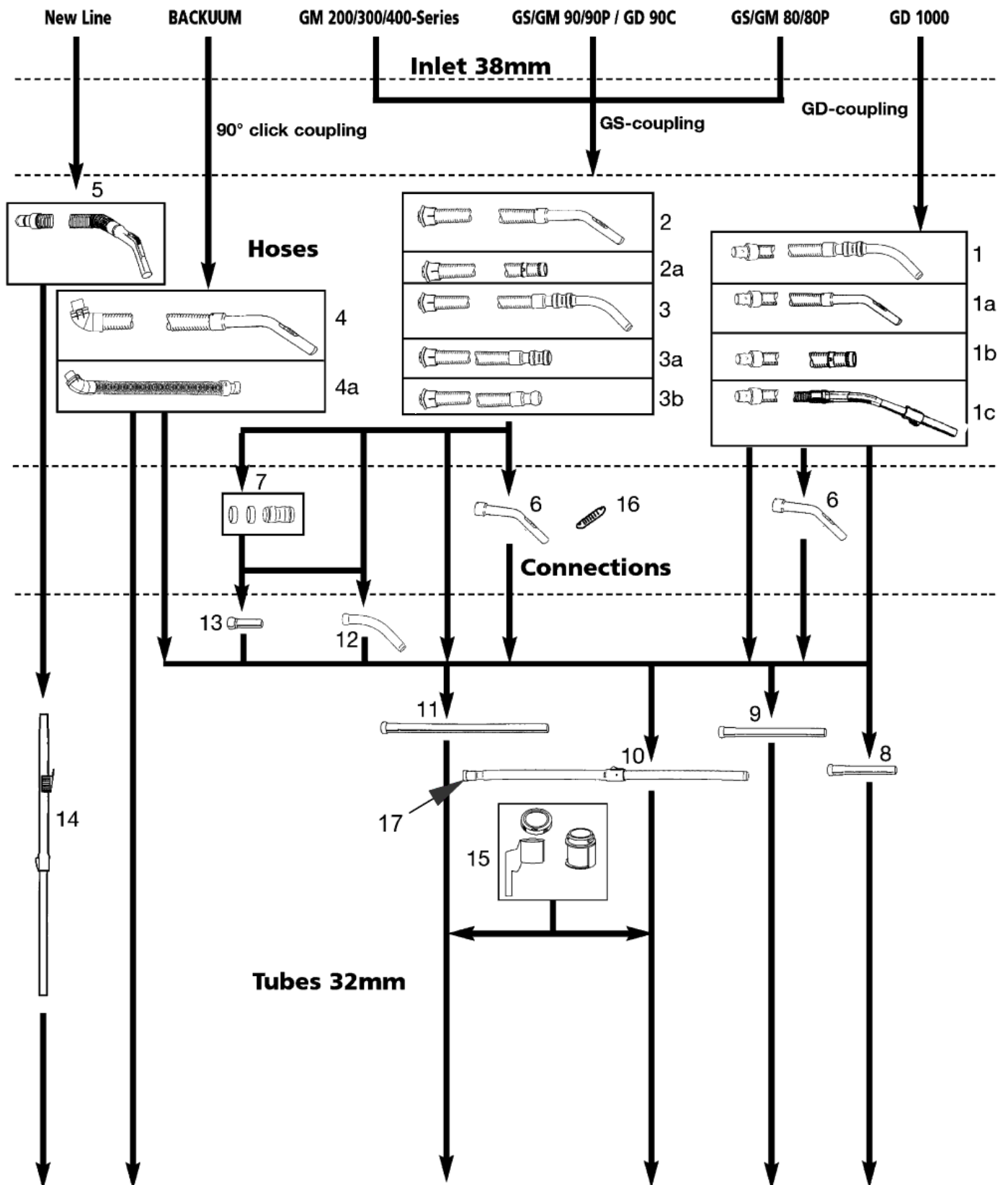

See
New-
Line
nozzles

See
nozzles
for
32mm

EINLASSKUPPLUNG UND SCHLÄUCHE 38-32 M

G 90 series Consumer

08-02-2015

ET-Liste-Nr.

A09315

16

Pos	Artikelnr.	Me	Beschreibung
0	11543700	1	HOSE 32/38/2M RUBB BALL-B
2	12041500	1	Schlauch PVC Baj. mit Rohrbogen PVC
3	11717000	1	Schlauch gummi mit Baj. +Metallbogenr./2
3	12097500	1	Schlauch PVC/ Baj. metall Rohrbogen 32/200
6	21640503	1	Rohrbogen PVC / 32mm
7	22344400	1	Muffe-Kit 32mm
7	22344600	1	Verbindungs muffenkit 32mm
8	11182500	1	Verlängerung 32/200
9	11112401	1	Stahlrohr gerade 32/560
10	81906500	1	TUBE TELESC. LENGTH MAX 1130 MM
11	11262400	1	Rohr Alu 32/1000
12	107402630	1	Anschlussstück D32, ge-
13	11141900	1	Rohr metall gerade m. Kuge 32/140
15	22147600	1	PARKERINGSKLIPS KOMPL.
16	22351000	1	Luftventil (5 Stück)
17	81948300	1	Rohrring für Teleskoprohr gibt es nicht m
2A	22041400	1	Kon. Plastischl. o. Rohr
3A	11543600	1	Schlauch 2 m / 32 mm verstärkt
3A	12097600	1	HOSE 38/32MM 2M PLASTIC
3B	22097400	1	Schlauch KS Bay o-Kugel

DÜSEN 32 MM

G 90 series Consumer

08-02-2015

ET-Liste-Nr.

A09317

17

See hose
connection
diagram for
38mm hoses

32

See hose con-
nection
diagram
for Tapered
38/32mm
and 32mm

Brushes & nozzles

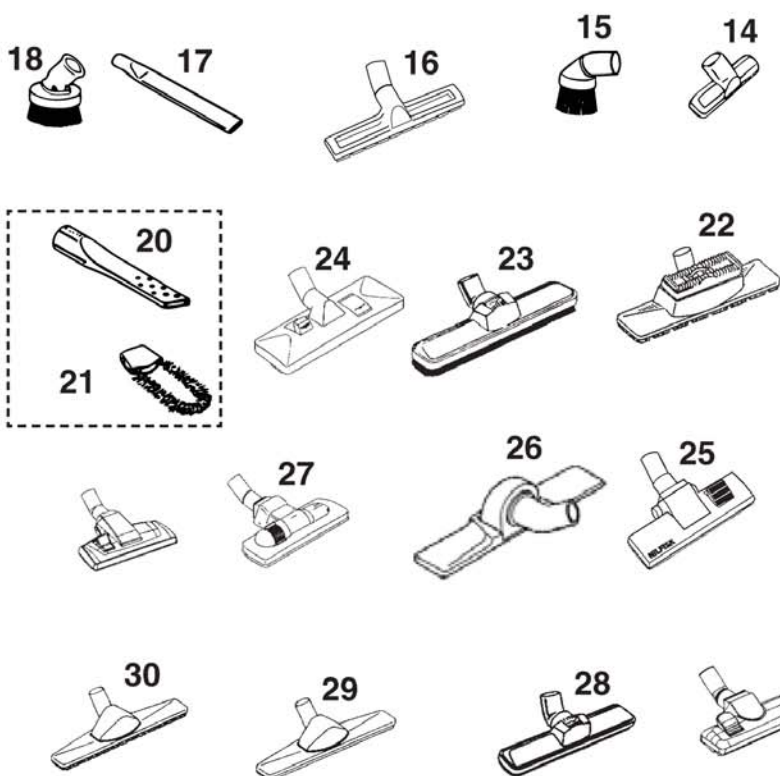

Aluminium nozzle with adjustable lips

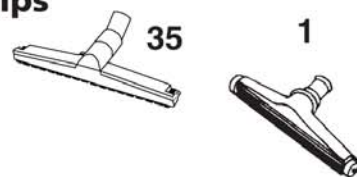

Flexible nozzles

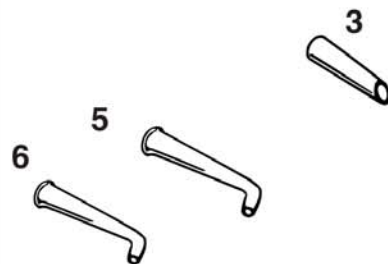

Special nozzle

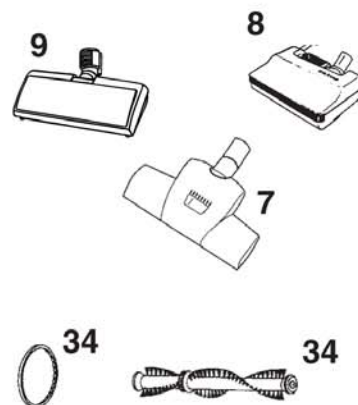

Pre-serarators 36

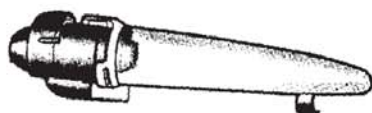

Pelican

33



NilfiskMop

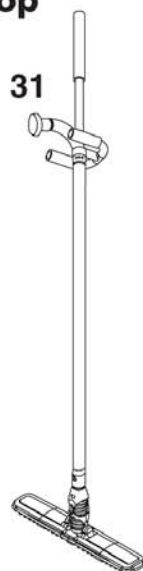

Nozzles with parking clip for GD 1000

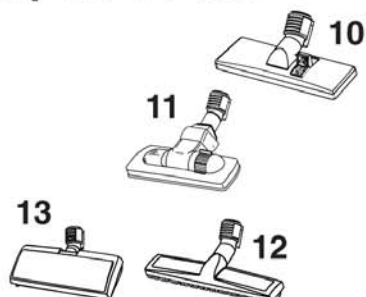

DÜSEN 32 MM

G 90 series Consumer

08-02-2015

ET-Liste-Nr.

A09317

18

Pos	Artikelnr.	Me	Beschreibung
3	22302100	1	CREVICE NOZZLE BLACK
3	81140900	1	CREVICE NOZZLE KIT
7	22360000	1	Turbodüse sz / 32mm
14	22302300	1	FURNITURE NOZZLE
14	32043700	1	Polsterdüse mit Einsatz 32/120
16	22351400	1	Hartbodendüse schwarzmit Rollen 29.5 cm
20	81530400	1	Fugendüse gelocht PVC32-250mm
21	11530500	1	RADIATORBØRSTE
22	22359800	1	Kombidüse sz / 32mm
24	11980300	1	Kombidüse 2stufig27cm
27	22359800	1	Kombidüse sz / 32mm
33	22424800	1	Pelicandüse
34	81684500	1	Bürste zu Turbodüse
34	81684600	1	ANTRIEBSRIEMEN ESB 10932mm
36	140 7700 000	1	PRE SEPARATOR CYCLONE PHASE 1